



DUAL INTENSITY RAINWATER HARVESTING FILTERS

Technical Specifications & Parameters:

Rainy FL-100

Suitable up to roof area:	110 SQMTRS
Max: Intensity of Rainfall:	75 mm/hr
Working Principle:	Cohesive Force & Centrifugal force
Operating Pressure:	Less Than 2 foot of head (0.060kg/cm ²)
Capacity:	105 LPM
Filter Element:	SS-304 Screen
Mesh Size:	250
Inlet:	90 MM
Clean Water Outlet:	63 MM
Drain Outlet:	90 MM
Housing:	High Density Polyethylene
Efficiency Of Filter:	Above 90 %
Source of power:	Gravity

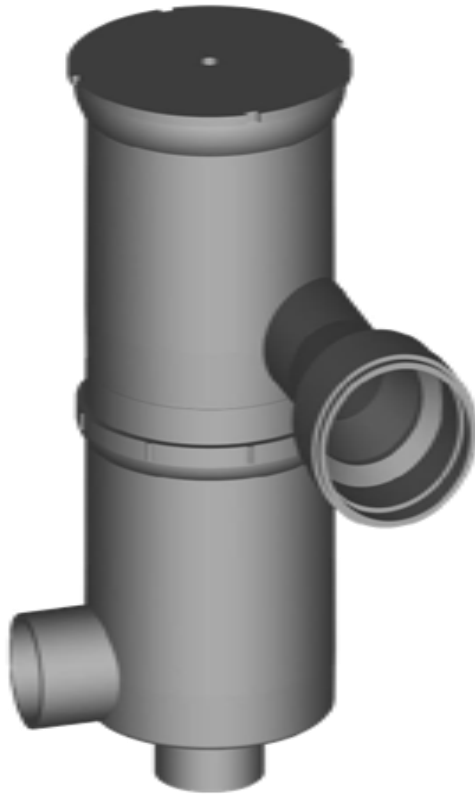



DUAL INTENSITY RAINWATER HARVESTING FILTERS



Technical Specifications & Parameters:

Rainy FL-200

Suitable up to roof area: 225 SQMTRS

Max: Intensity of Rainfall: 75 mm/hr

Working Principle: Cohesive Force &
Centrifugal force

Operating Pressure:	Less Than 2 foot of head
(0.060kg/cm²)	
Capacity:	225 LPM
Filter Element:	SS-304 Screen
Mesh Size:	250
Inlet:	110 MM
Clean Water Outlet:	75 MM
Drain Outlet:	90 MM
Housing:	High Density
Polyethylene	
Efficiency Of Filter:	Above 90 %
Source of power:	Gravity



DUAL INTENSITY RAINWATER HARVESTING FILTERS



Technical Specifications & Parameters:

Rainy FL-300

Suitable up to roof area:	350 SQMTRS
Max: Intensity of Rainfall:	75 mm/hr
Working Principle:	Cohesive Force & Centrifugal force
Operating Pressure:	Less Than 2 foot of head (0.060kg/cm ²)
Capacity:	340 LPM
Filter Element:	SS-304 Screen
Mesh Size:	250
Inlet:	110 MM
Clean Water Outlet:	90 MM
Drain Outlet:	90 MM
Housing:	High Density Polyethylene
Efficiency Of Filter:	Above 90 %
Source of power:	Gravity



DUAL INTENSITY RAINWATER HARVESTING FILTERS

Installation is Simple `Rainy` –FL100



Rainwater Inlet

Drain Outlet

**Clean water
Outlet**



DUAL INTENSITY
RAINWATER HARVESTING FILTERS

Installation is Simple `Rainy` -FL200



Rainwater Inlet

**Clean water
Outlet**

Drain Outlet



DUAL INTENSITY
RAINWATER HARVESTING FILTERS

Installation is Simple `Rainy` -FL300



Rainwater Inlet

Drain Outlet

**Clean water
Outlet**



